

Přehled kladu listů

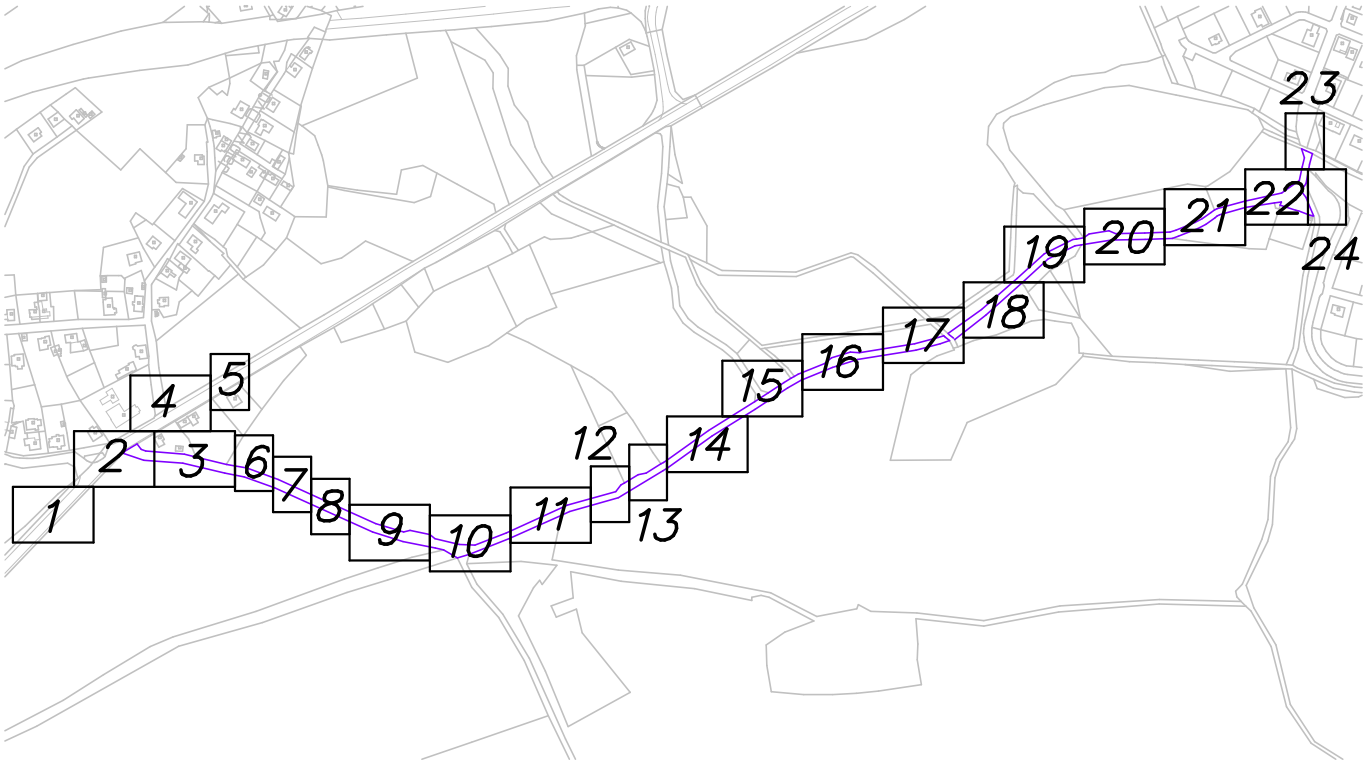

Legenda:

- 228 parcelní číslo stavební parcely
- 628 parcelní číslo pozemkové parcely
- hranice dle KN
- sloučená hranice dle KN
- 490 40 výška bodu (Bpv)
- □ □ betonový sloup, strom, patník, označnick
- S3 poloha a označení sondy
- rozsah věcného břemene dle KN

14.11.2022, c-48/2022

Zpracovatel  Ingera Písek, s.r.o. Jeronýmova 906/47, 397 01 PÍSEK [redacted]	Okres  Karlovy Vary	Souřadnicový systém  S-JTSK
	Obec  Hory	Výškový systém  Bpv
	Katastrální území  Hory u Jenišova	Formát Číslo zakázky 16x A3, 8x A4 69/2022
Vyhotovil: [redacted] dne 14.11.2022	Objednatel S-pro servis s.r.o., Pivovarská 1272, 38801 Blatná	Měřítko 1 : 200
k.ú. Hory u Jenišova – výškopisný a polohopisný plán Podklad pro projekt cesty VPC 6A		

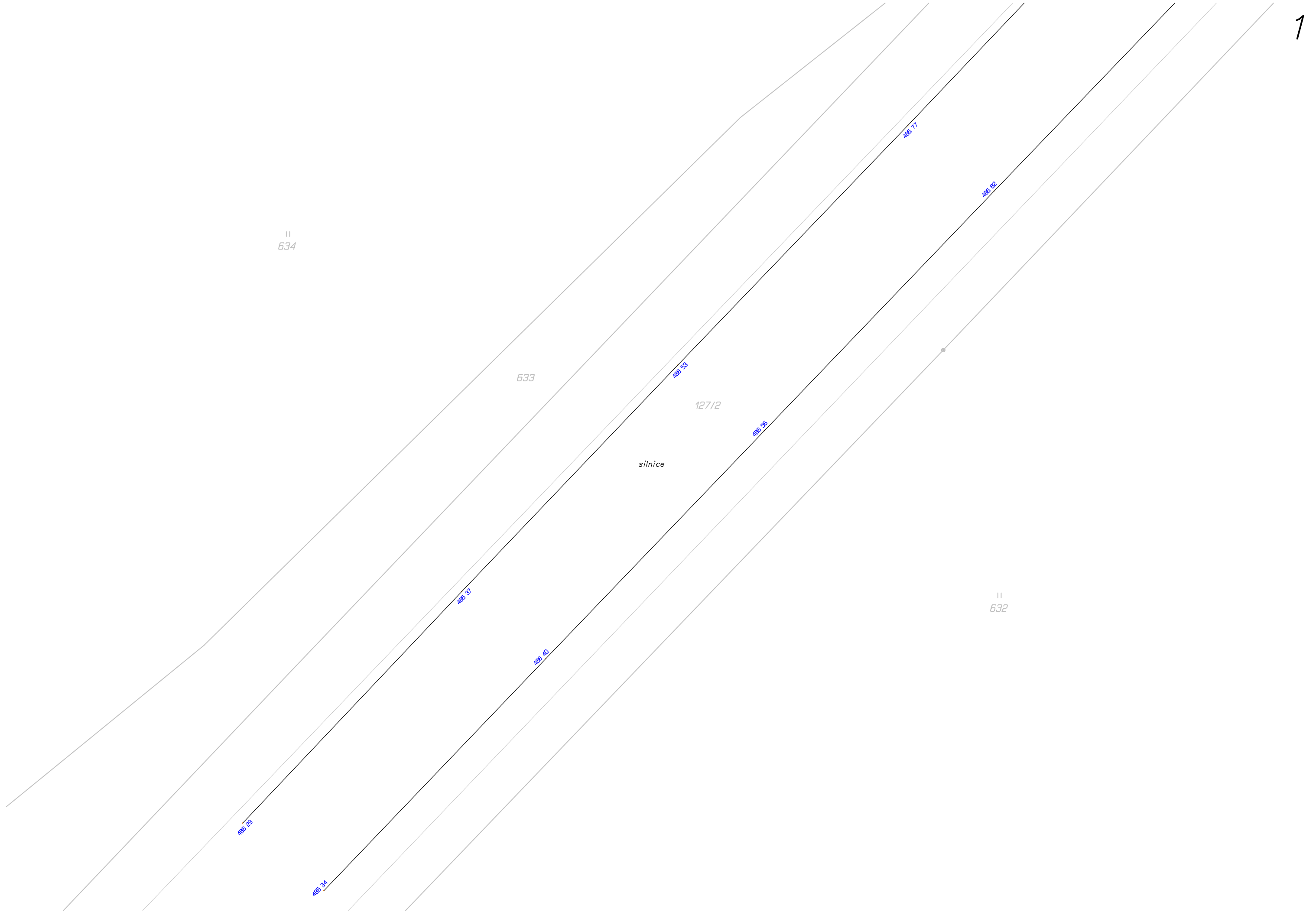

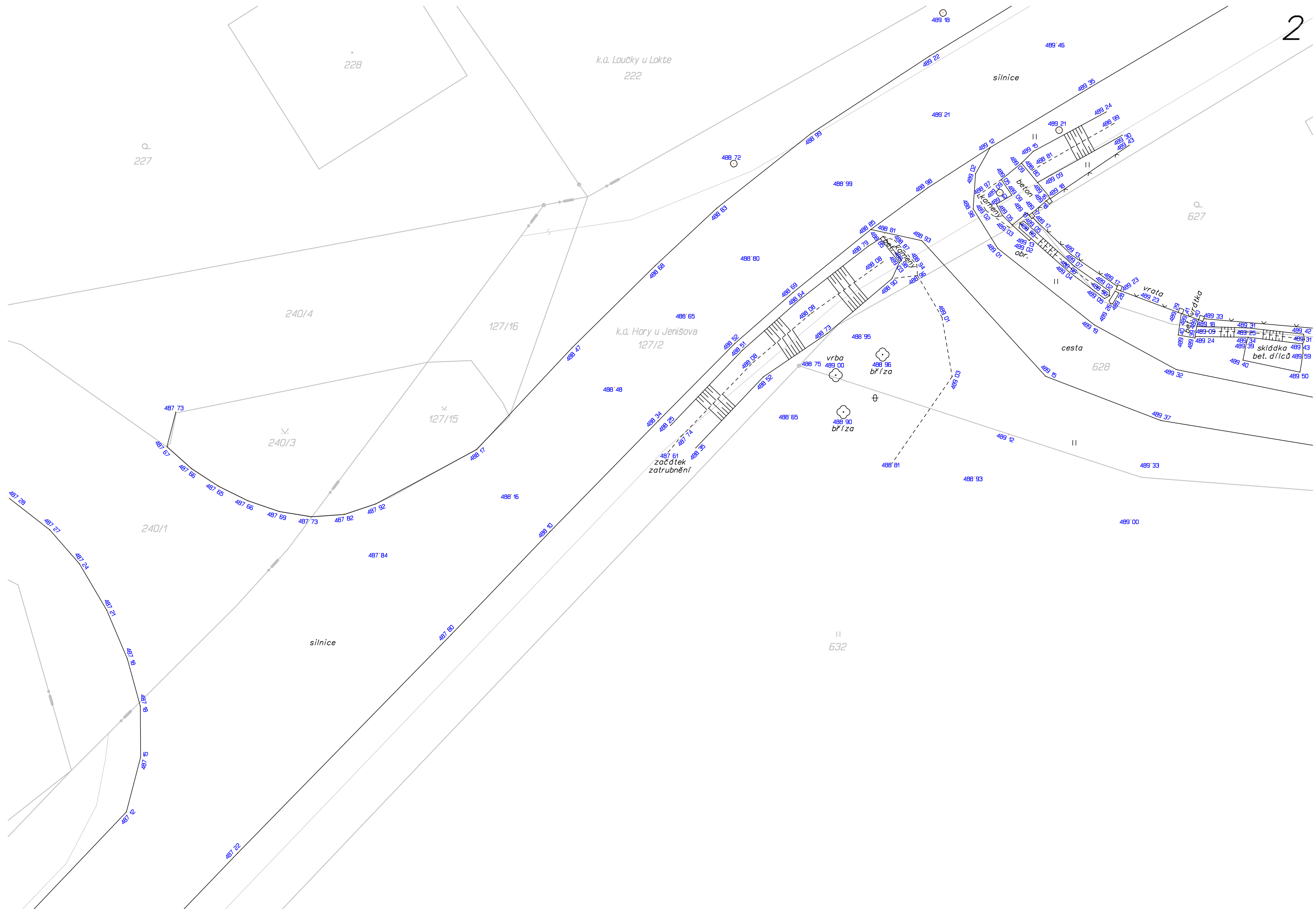

Q  
627Q  
626

11

cesta

11

628

632

616

tyčový označník  
491 08

cesta

11

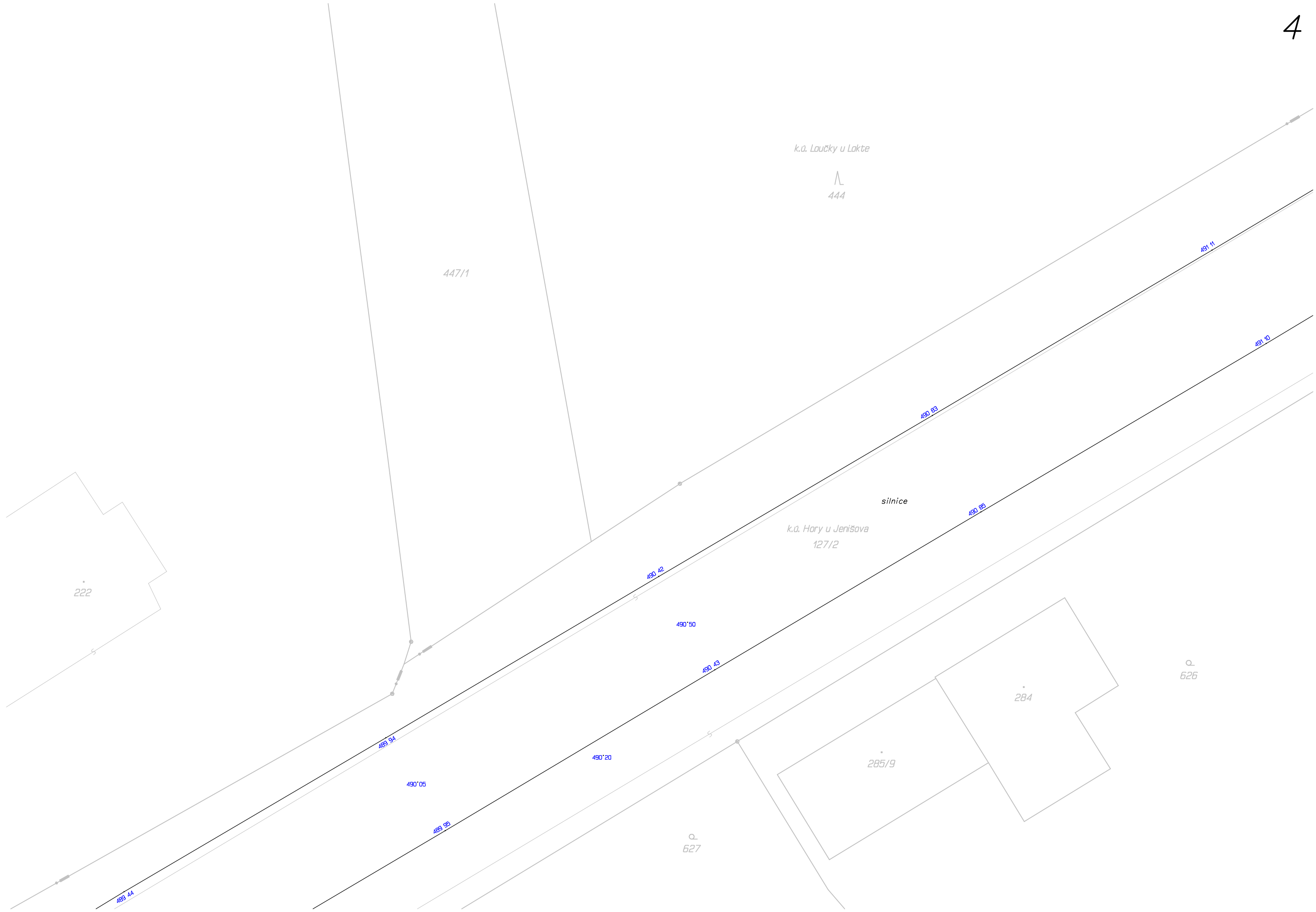



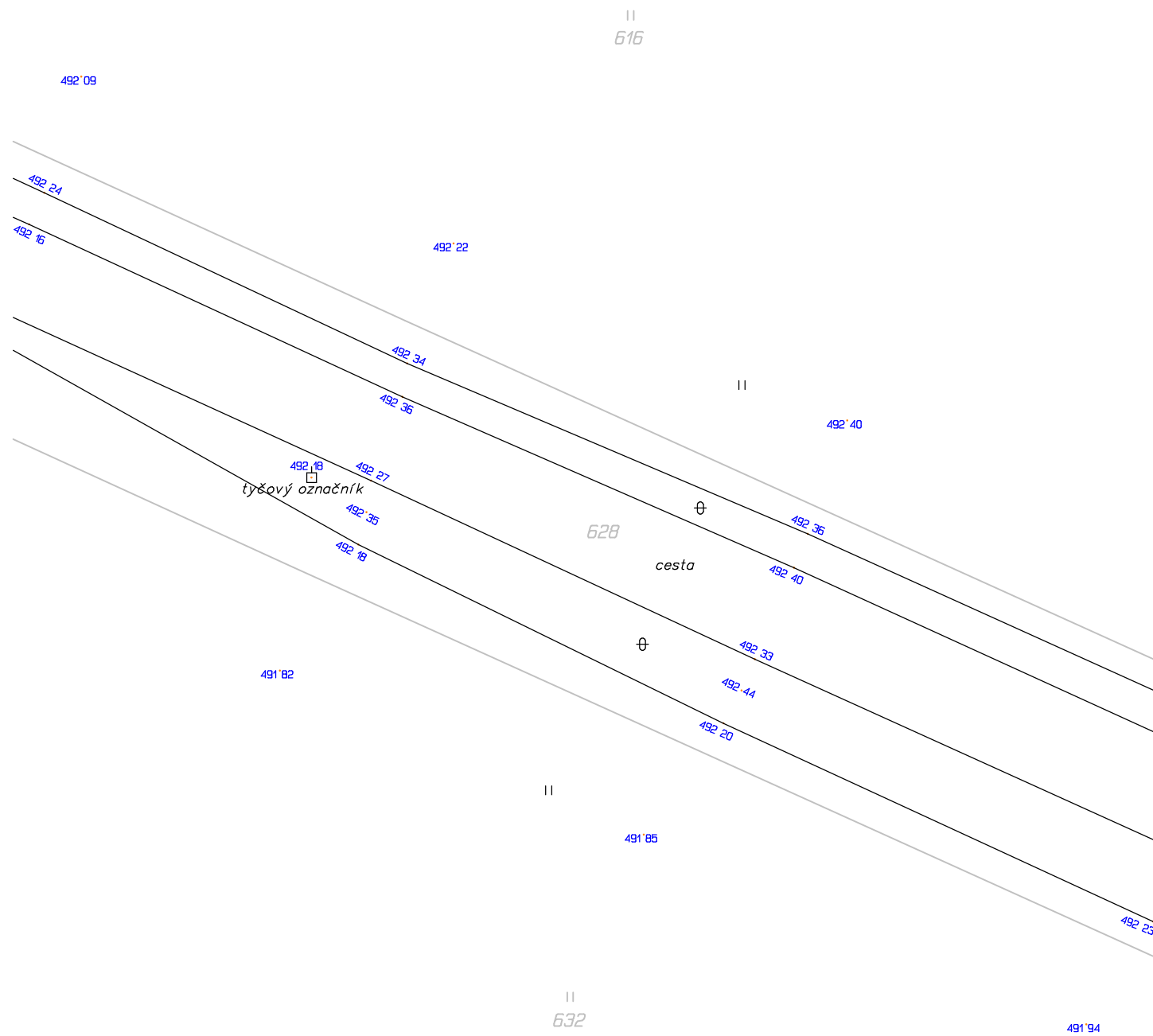
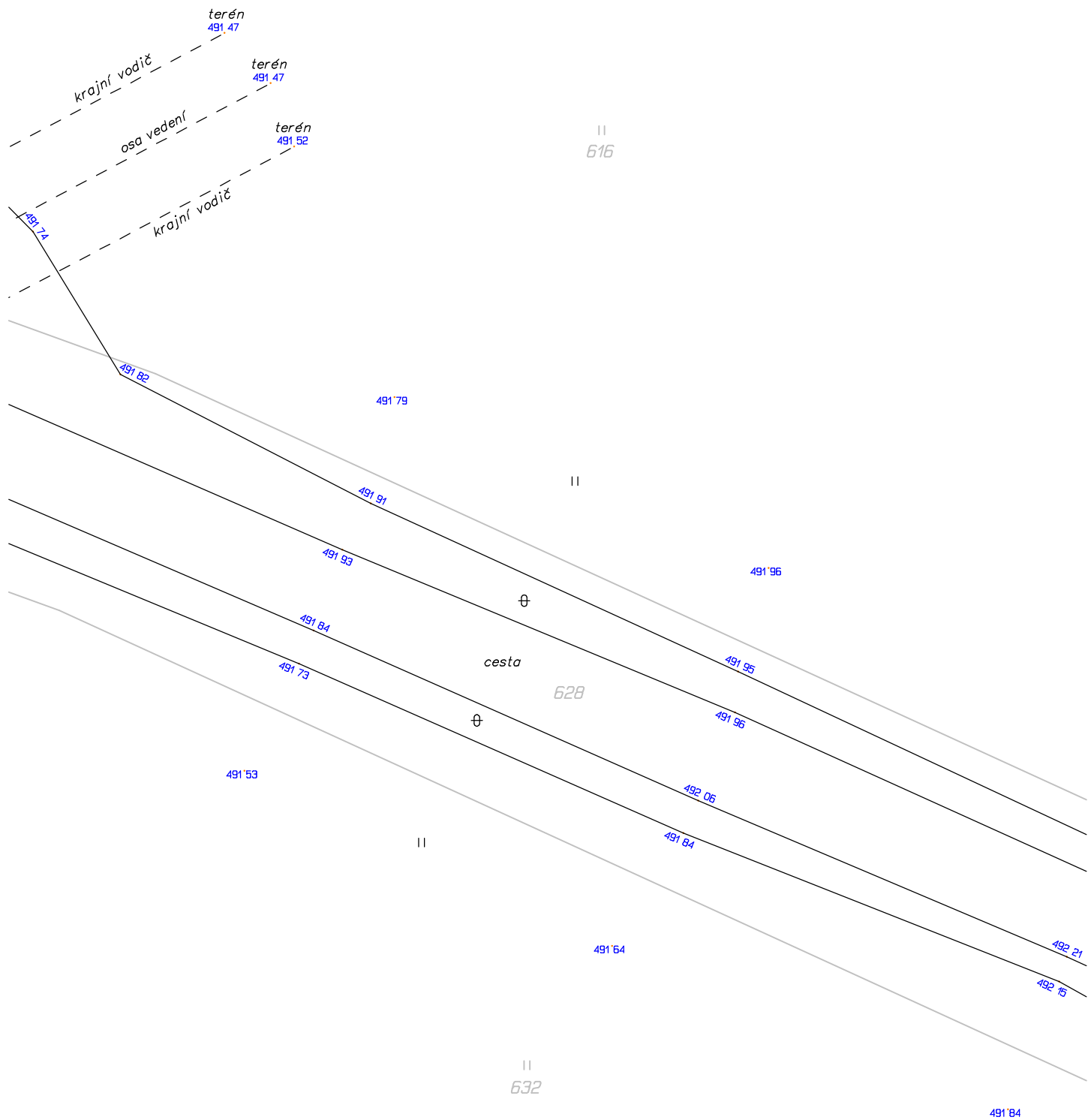





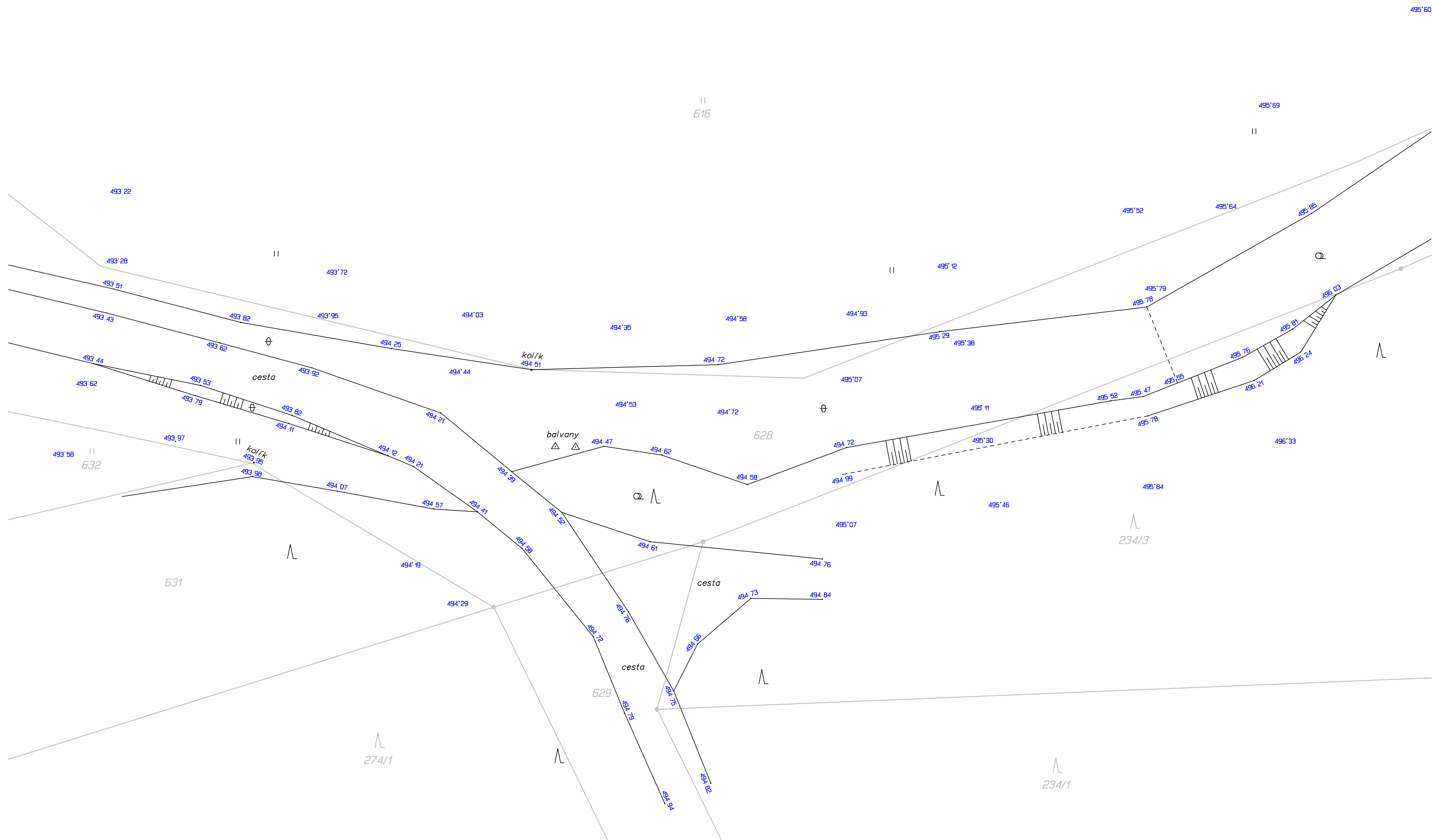

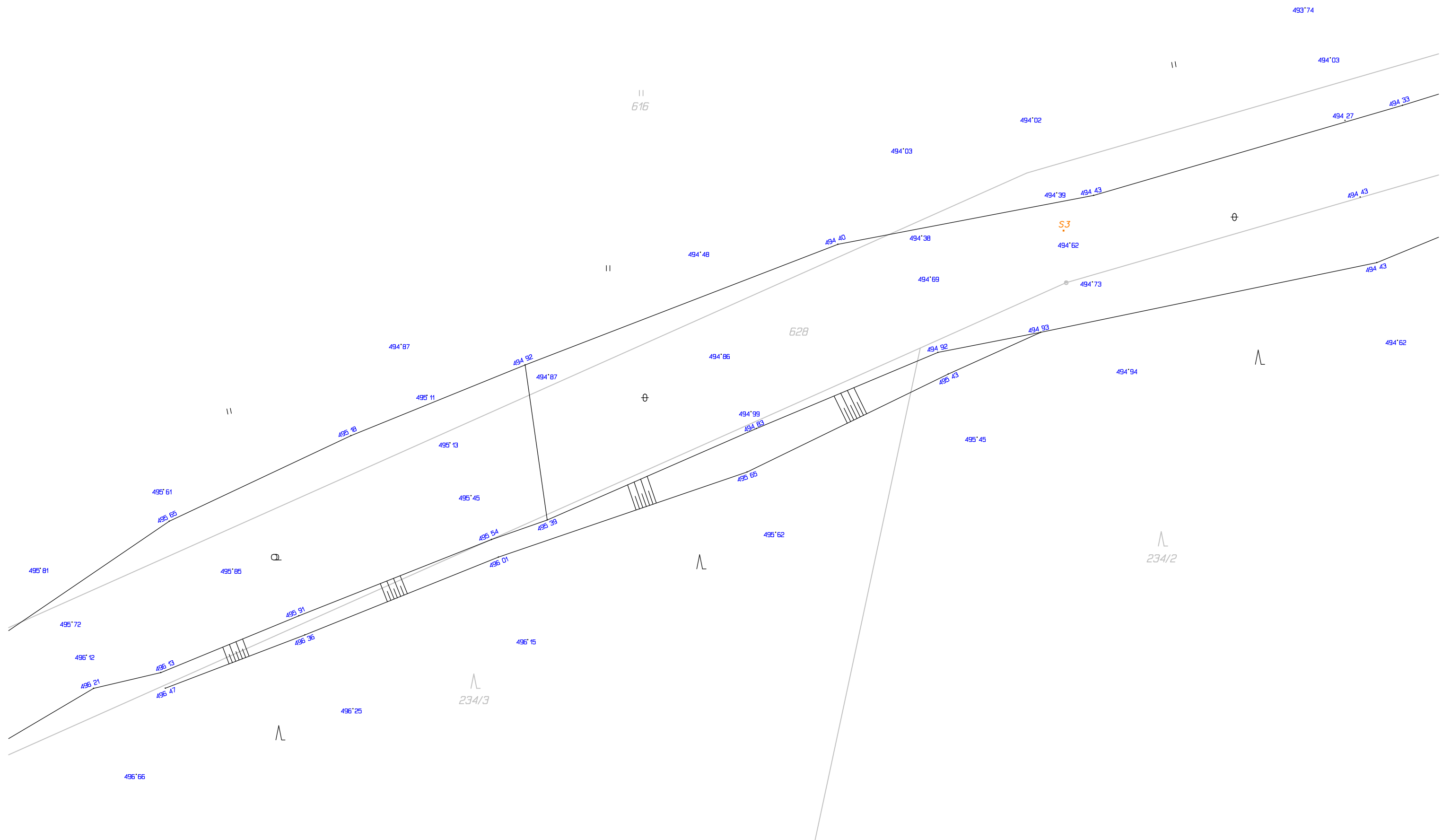

[illegible]

13

Technical drawing of a cadastral map showing land parcels, roads, and boundaries. The drawing includes numerous numerical labels (e.g., 493'60, 493'50, 493'44) and text labels (e.g., 'cesta', 'stružka'). A large number '13' is visible in the top right corner.

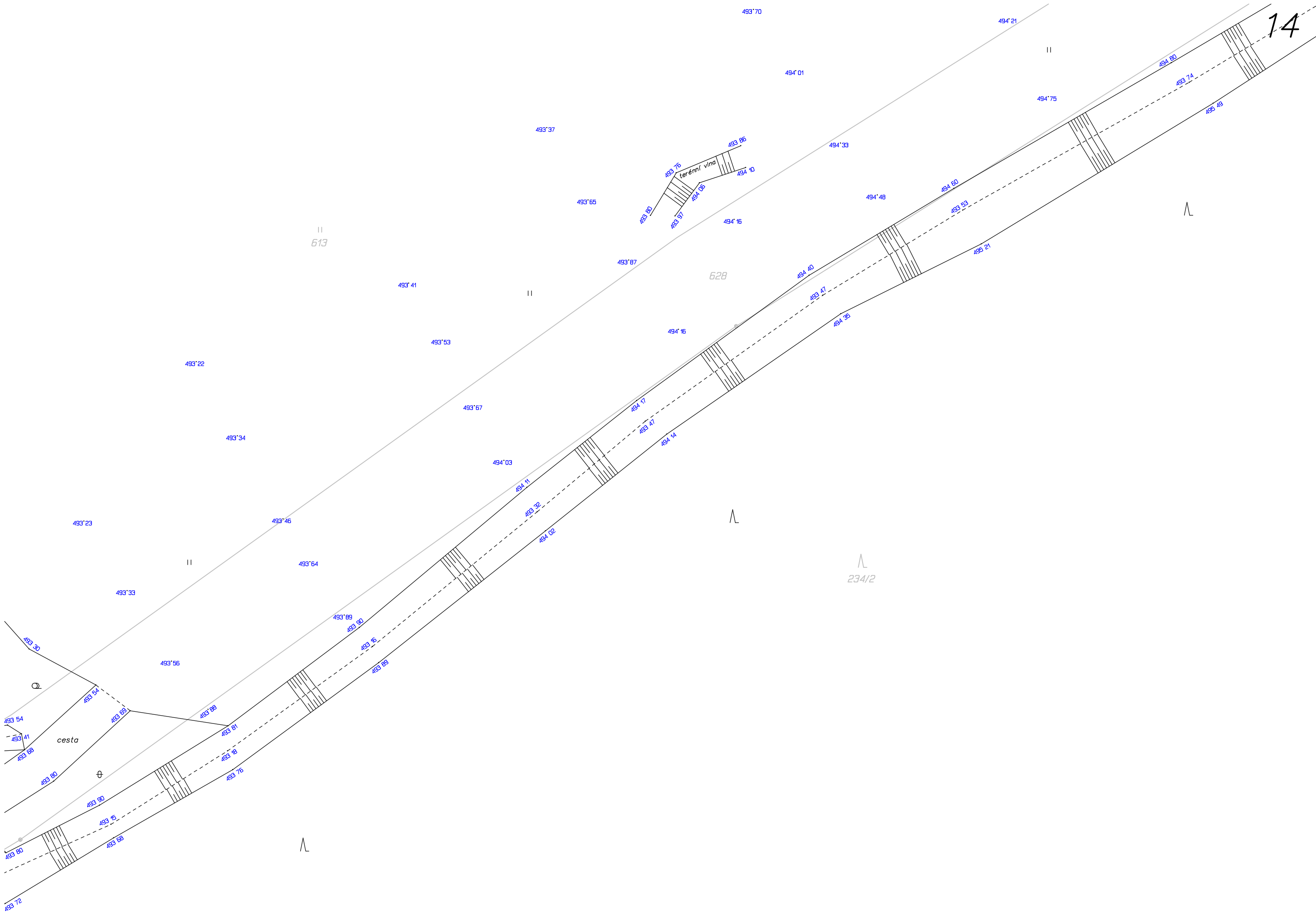

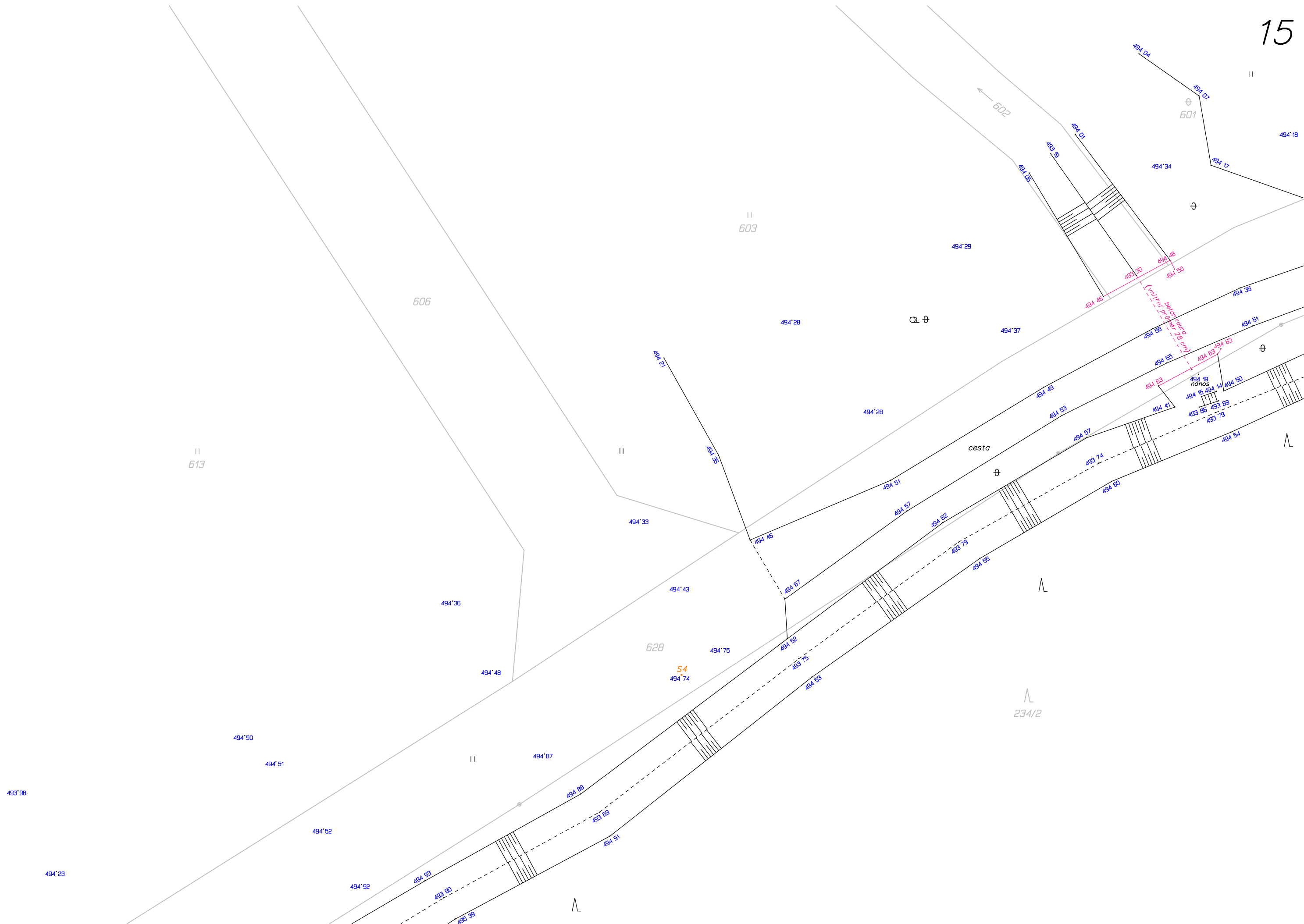

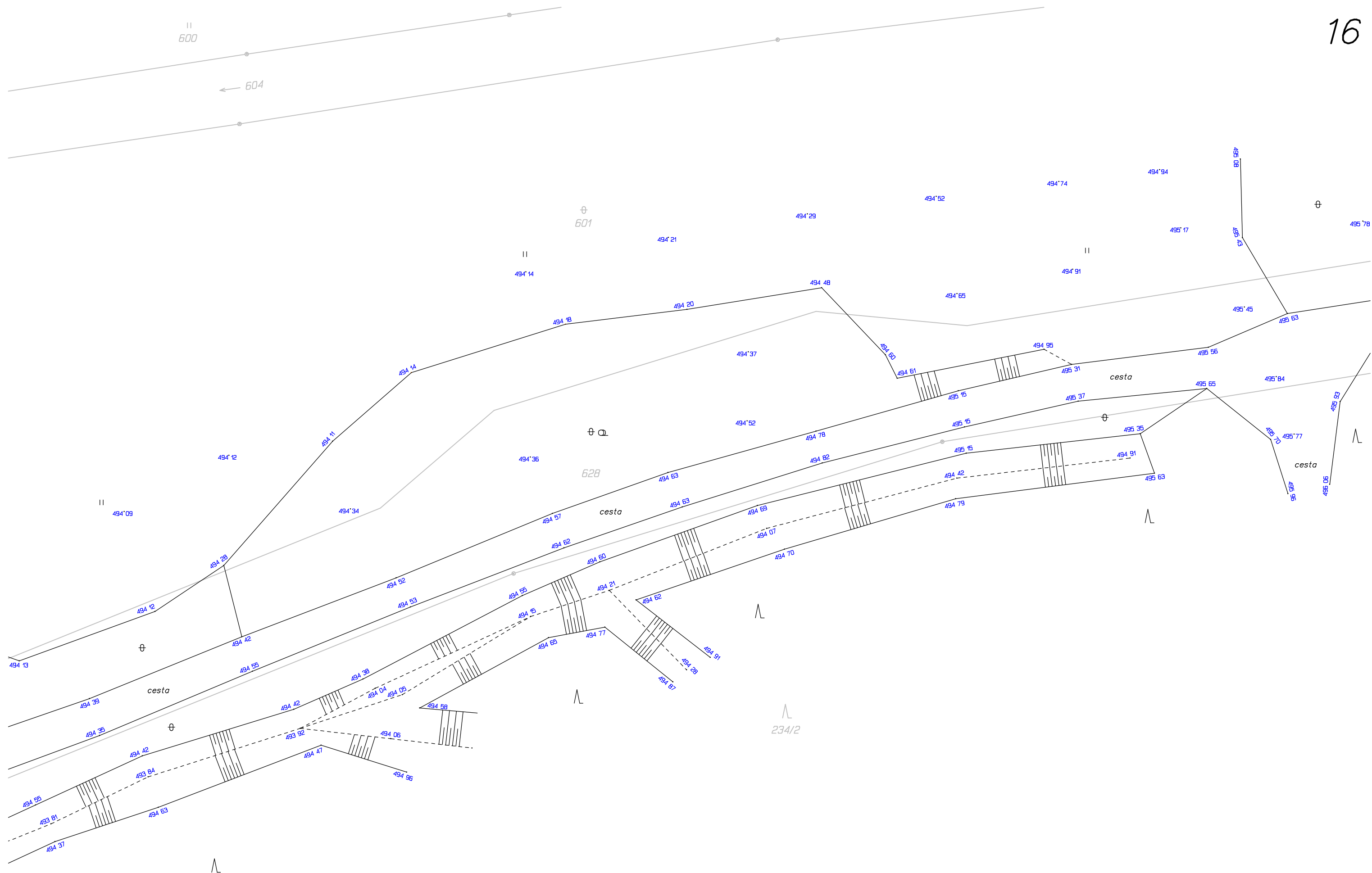

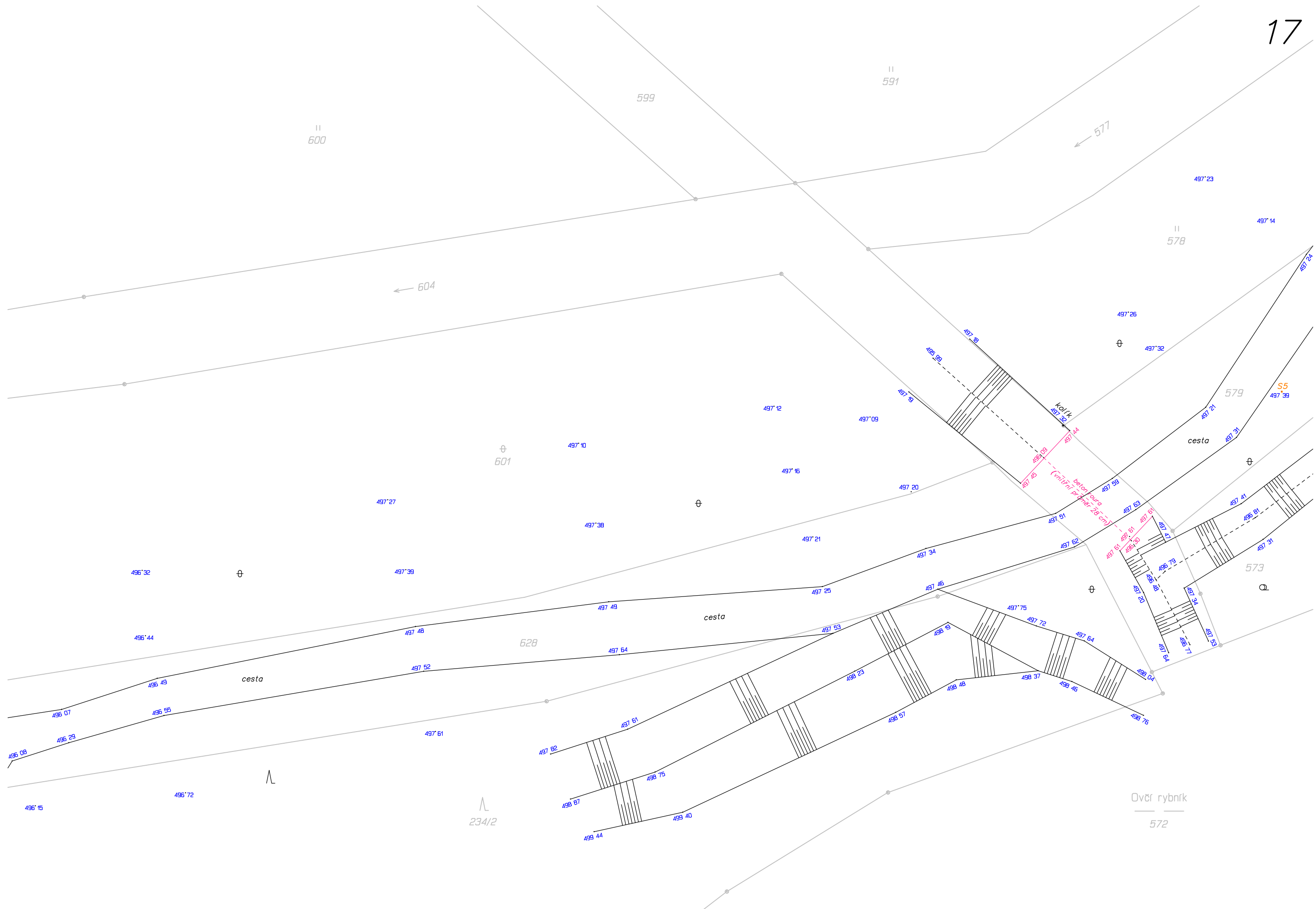

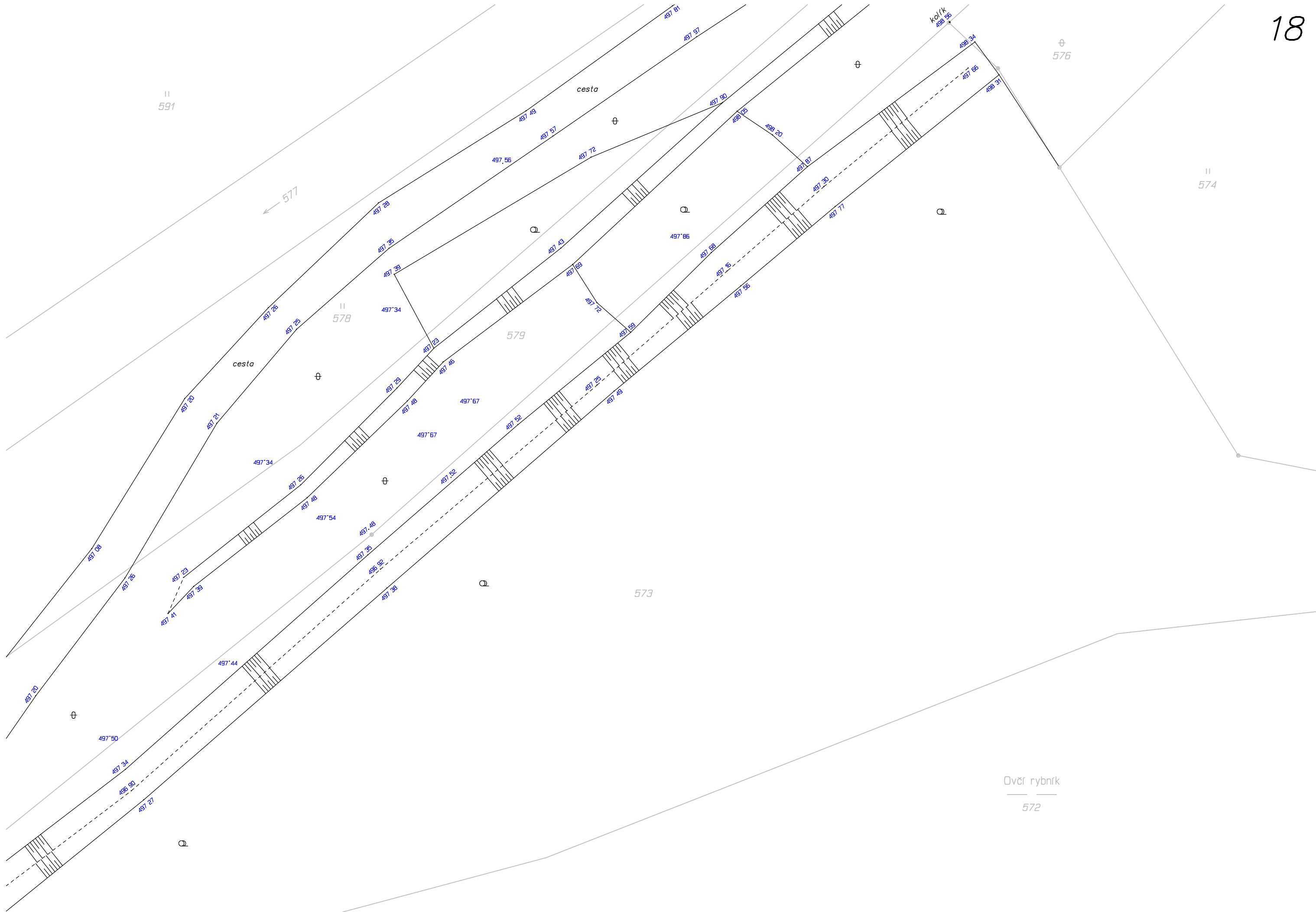



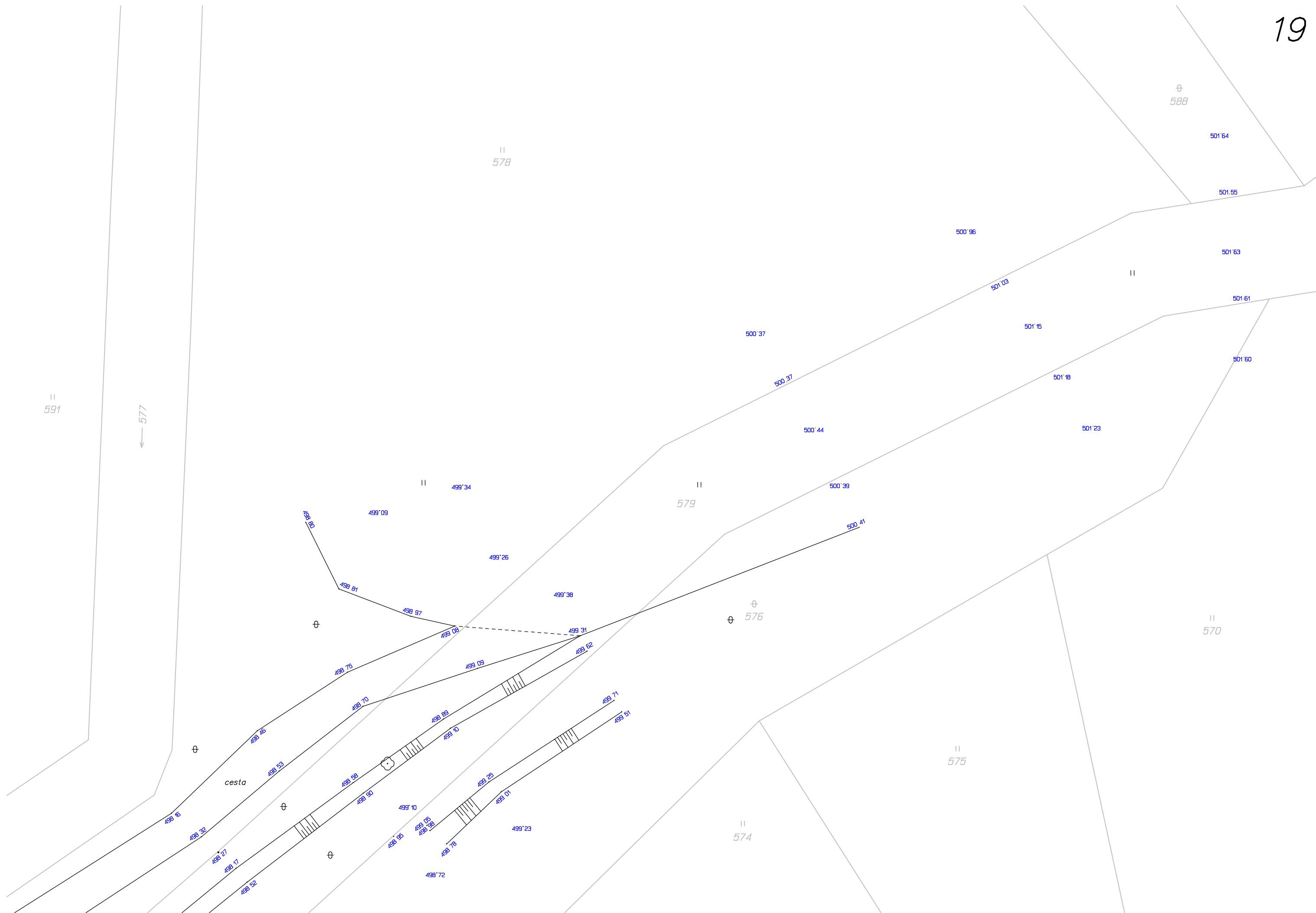

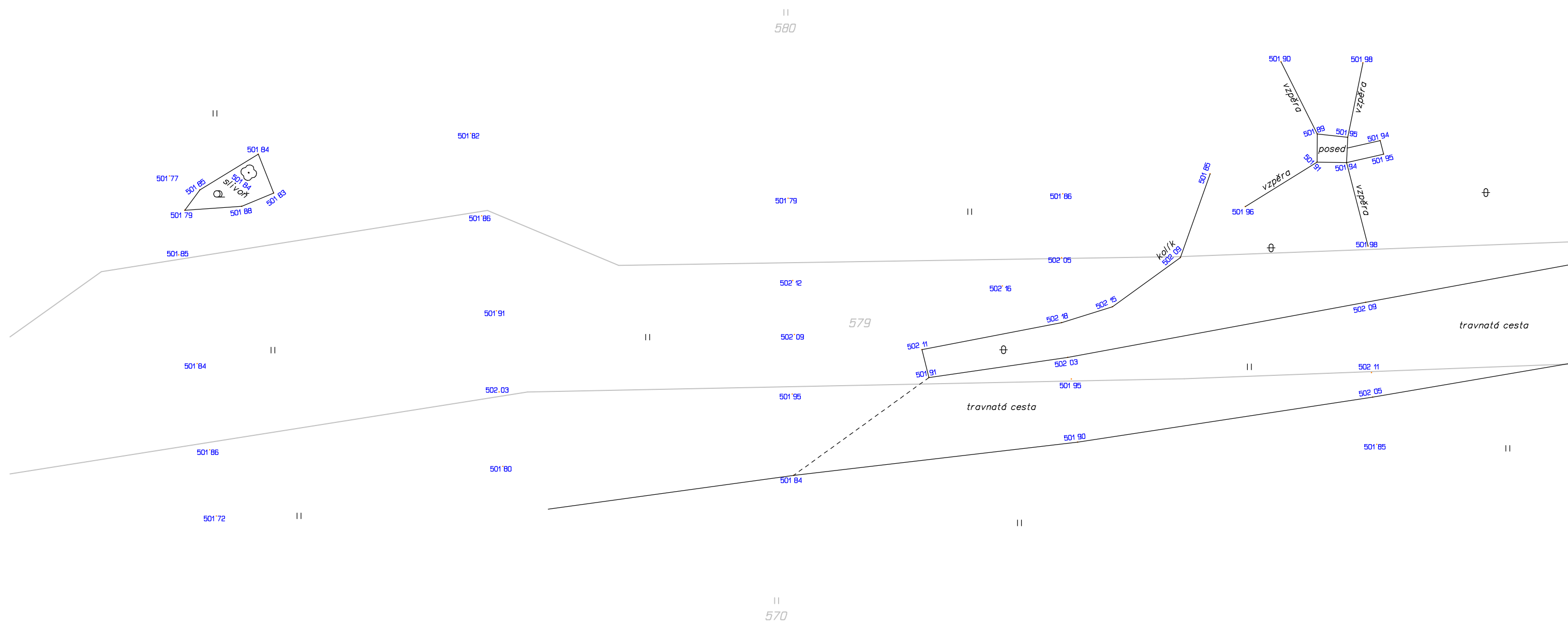

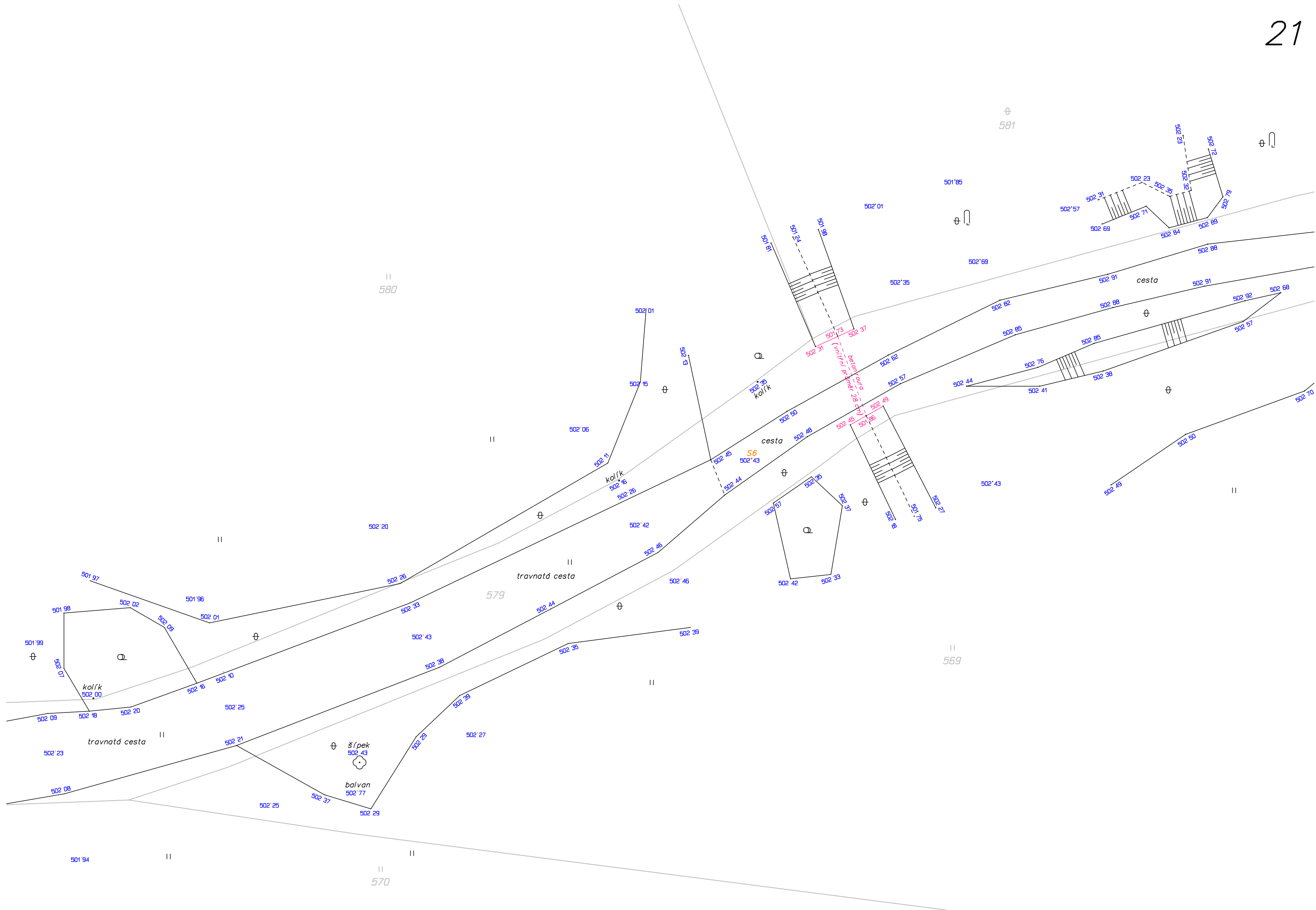

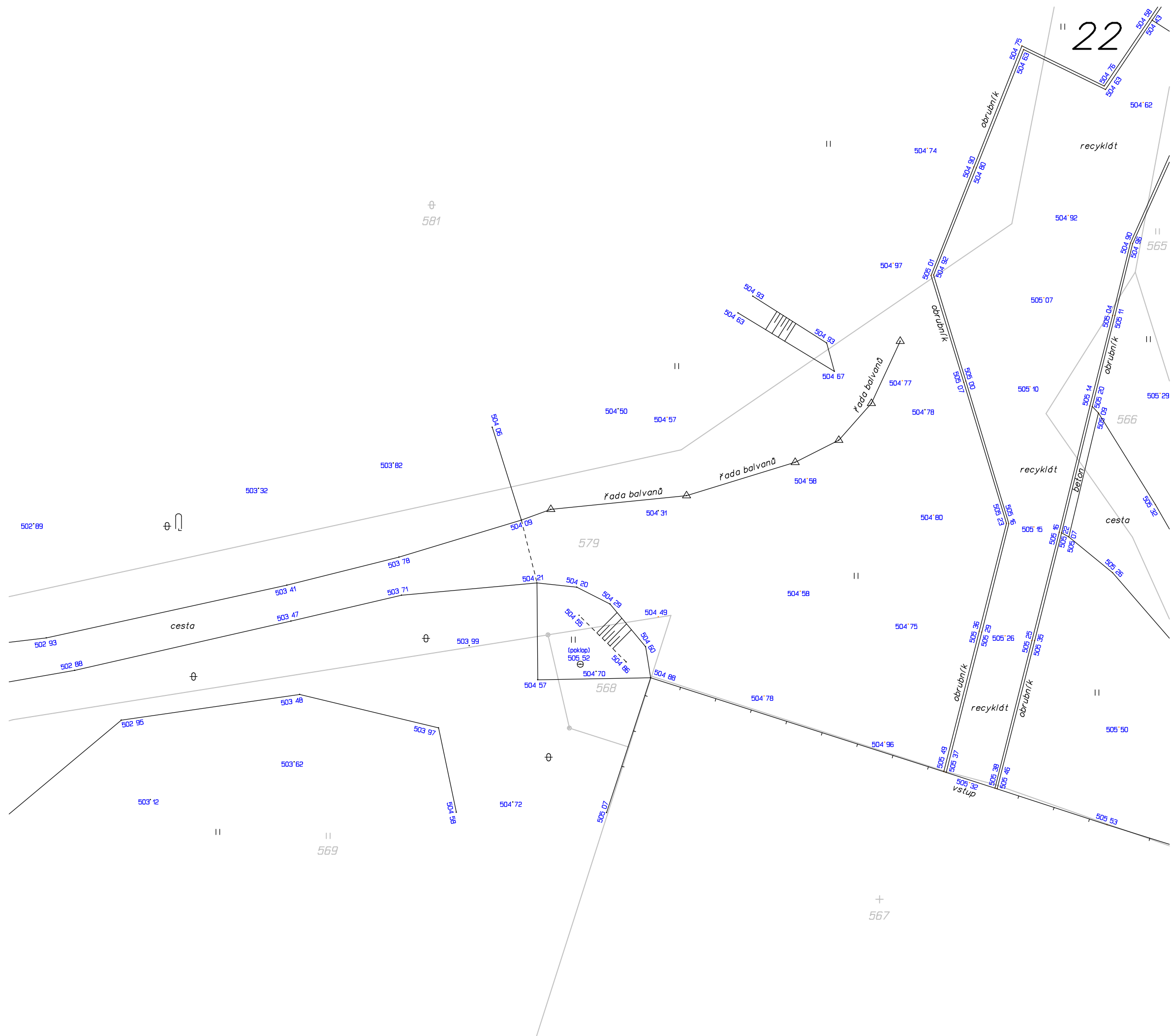

23

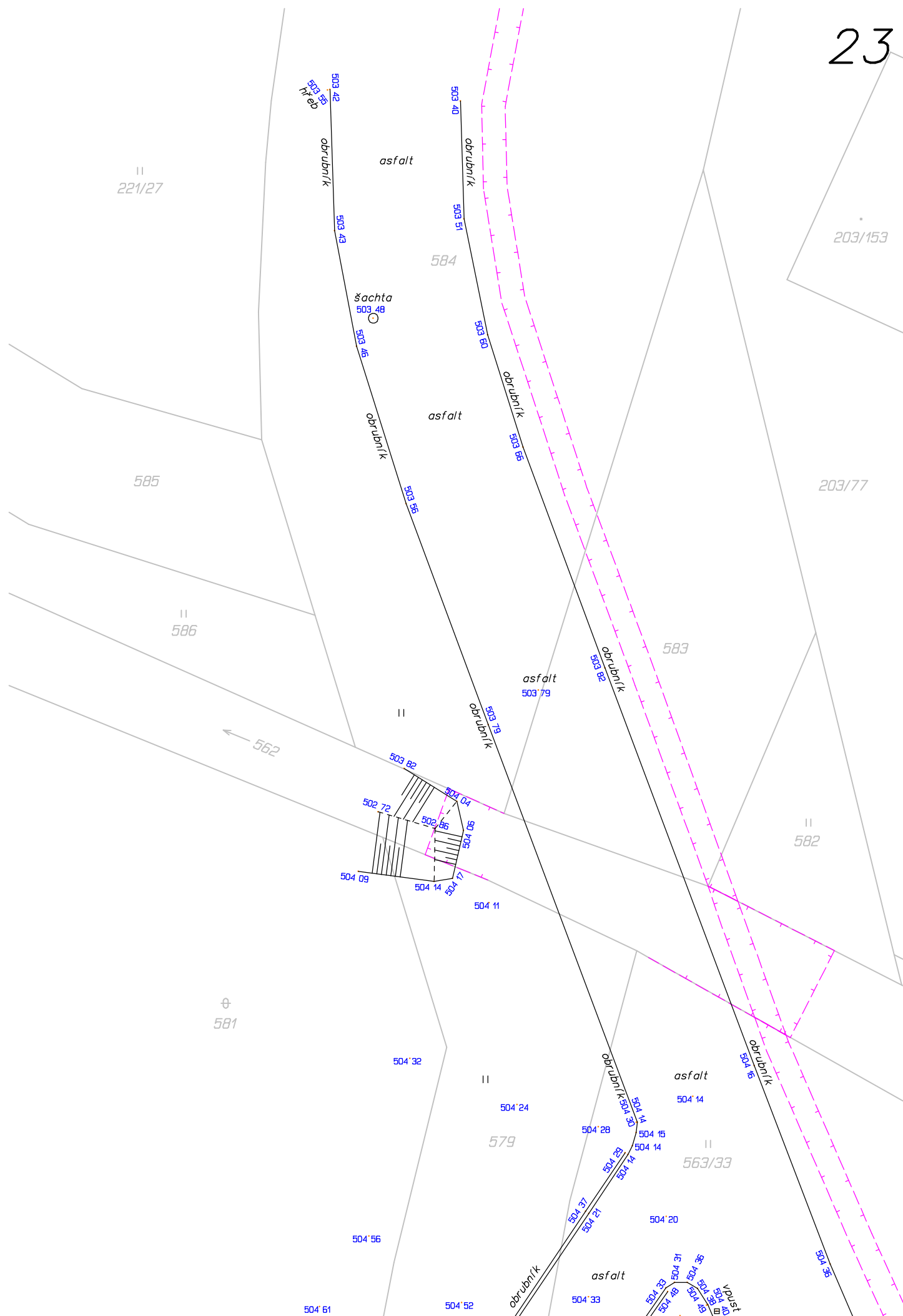

24

