

Třešňovka

Pnětluky u Podsedic

LV 10002

LV 489

LV 10002

138

50/17

50/9

162

140

50/11

LV 434

LV 430

50/20

LV 10002

50/27

50/25

141/1

Pnětluky u Podsedic

50/28

LV



159/2

159/1

158/1

157

155

156

50/22

158/2

153

154/2

LV 22

LV 500

LV 10002

154/1

152

50/8

Pnětluky u Podsedic

50/12

148

147

45

50/6

47

50/5

50/19

43/3

43/1

205

50/21

146/9

205

50/21

146/10

193

43/2

43/1

43/3

50/19

Pnětluky u Podsedic

Q
42/1

50/1

51/2

LV 10002

LV 500

LV 10002

50/13

50/14

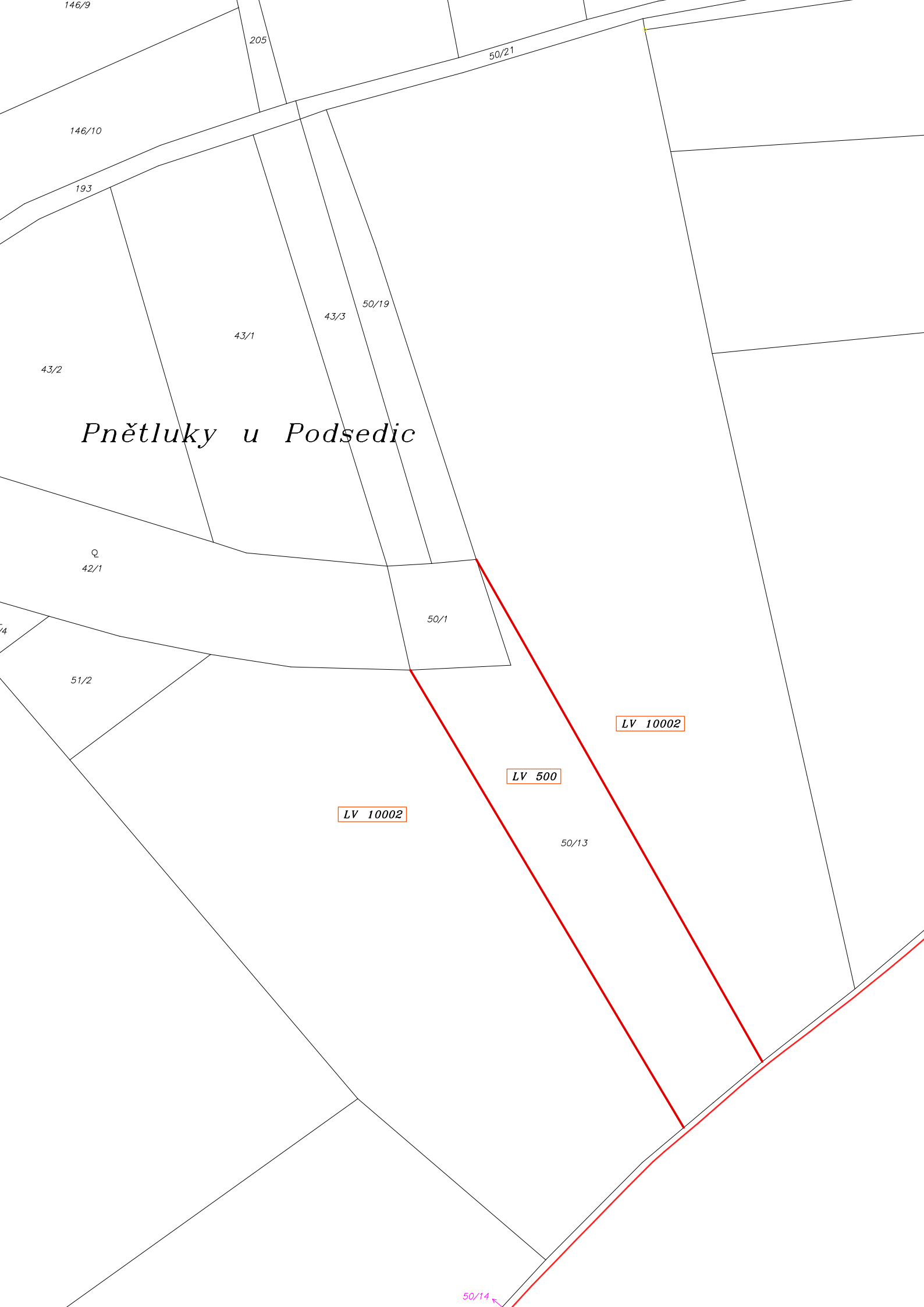

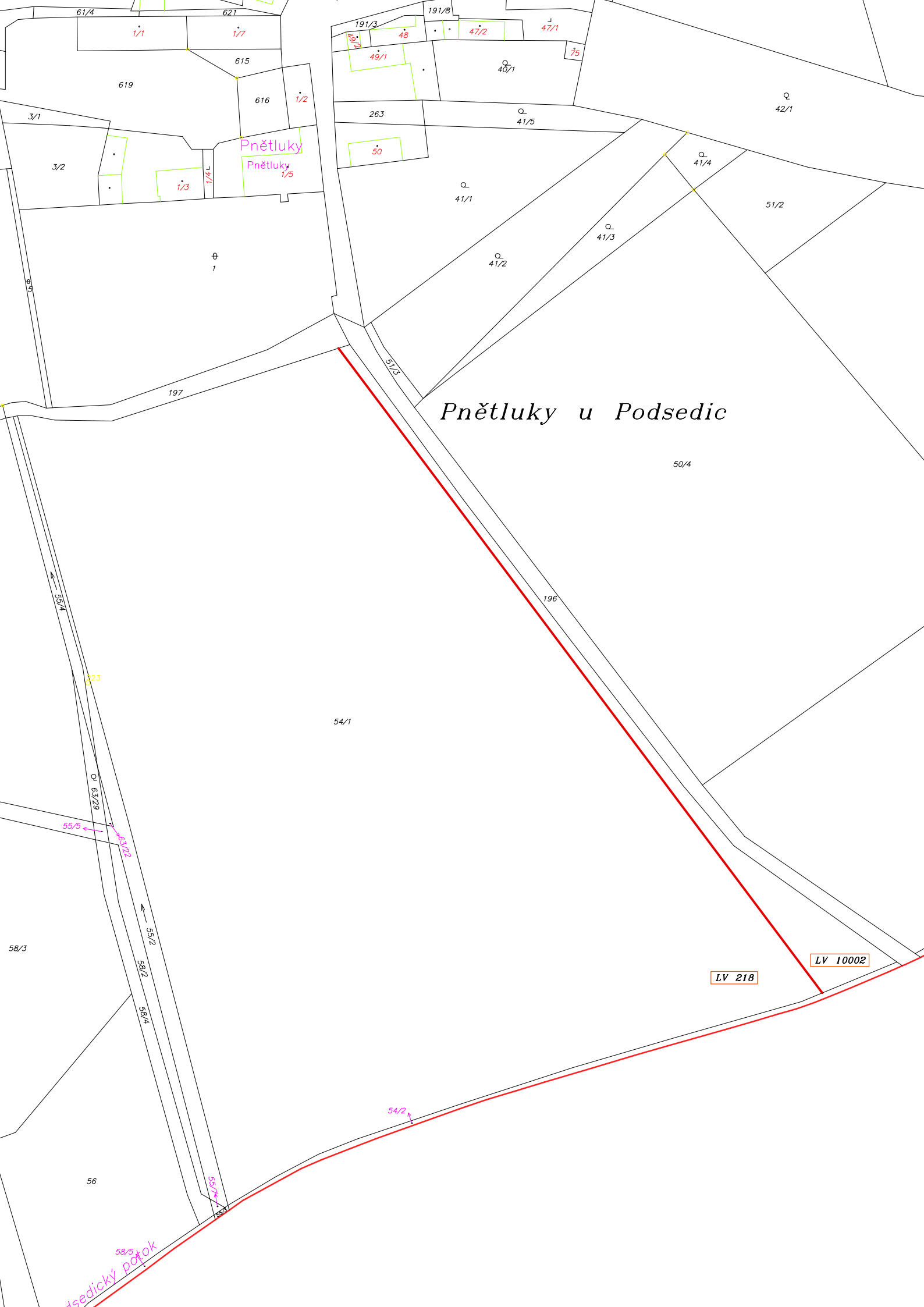

Pnětluky
Pnětluky
1/5

Pnětluky u Podsedic

LV 10002

LV 218

Podsedický pěták

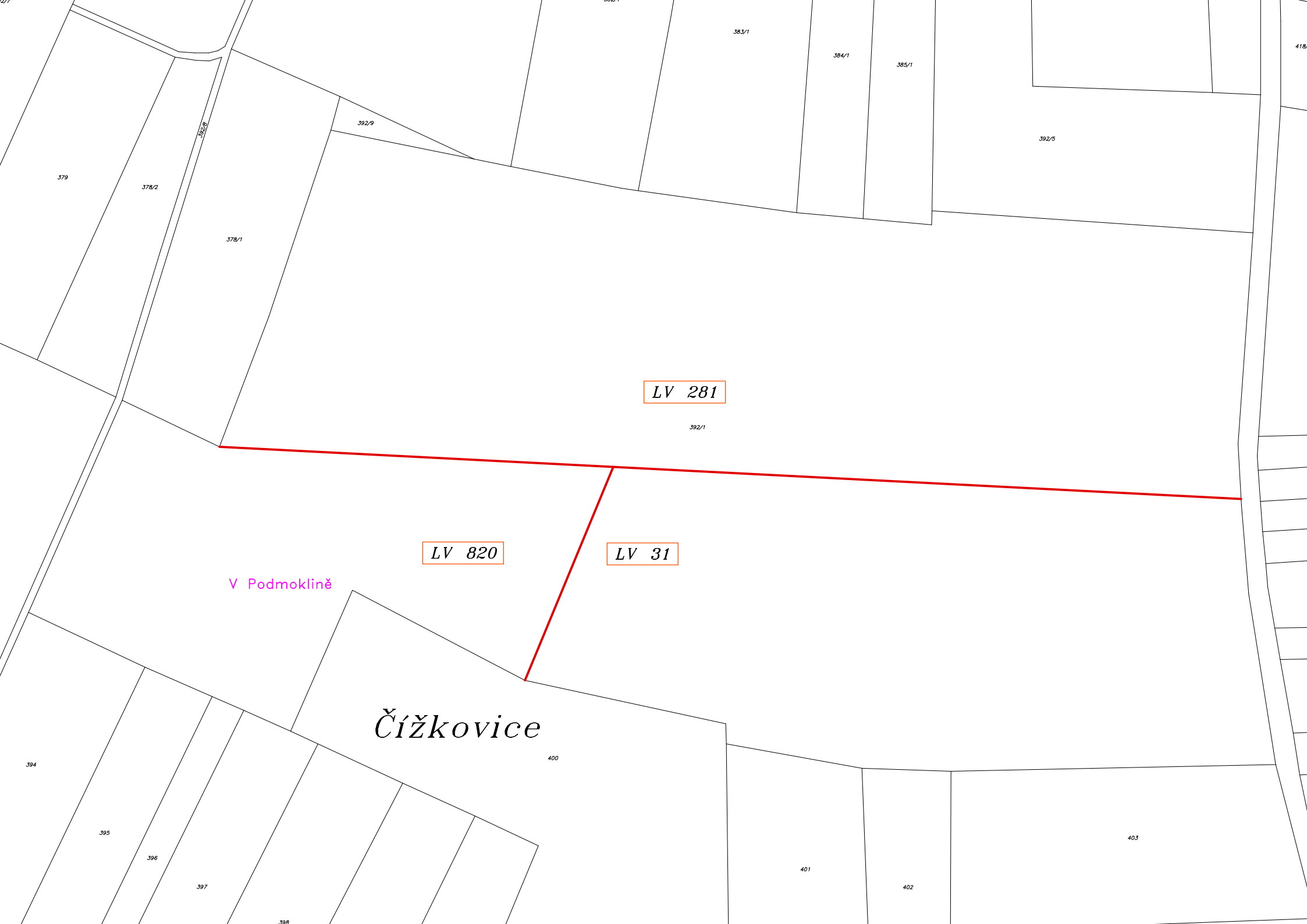

LV 281

392/1

LV 820

V Podmoklině

LV 31

Čížkovice

400

401

402

403

Čížkovice



413

412

392/6

LV 31

LV 818

LV 278

392/3

LV 31

392/2

LV 31

LV 31

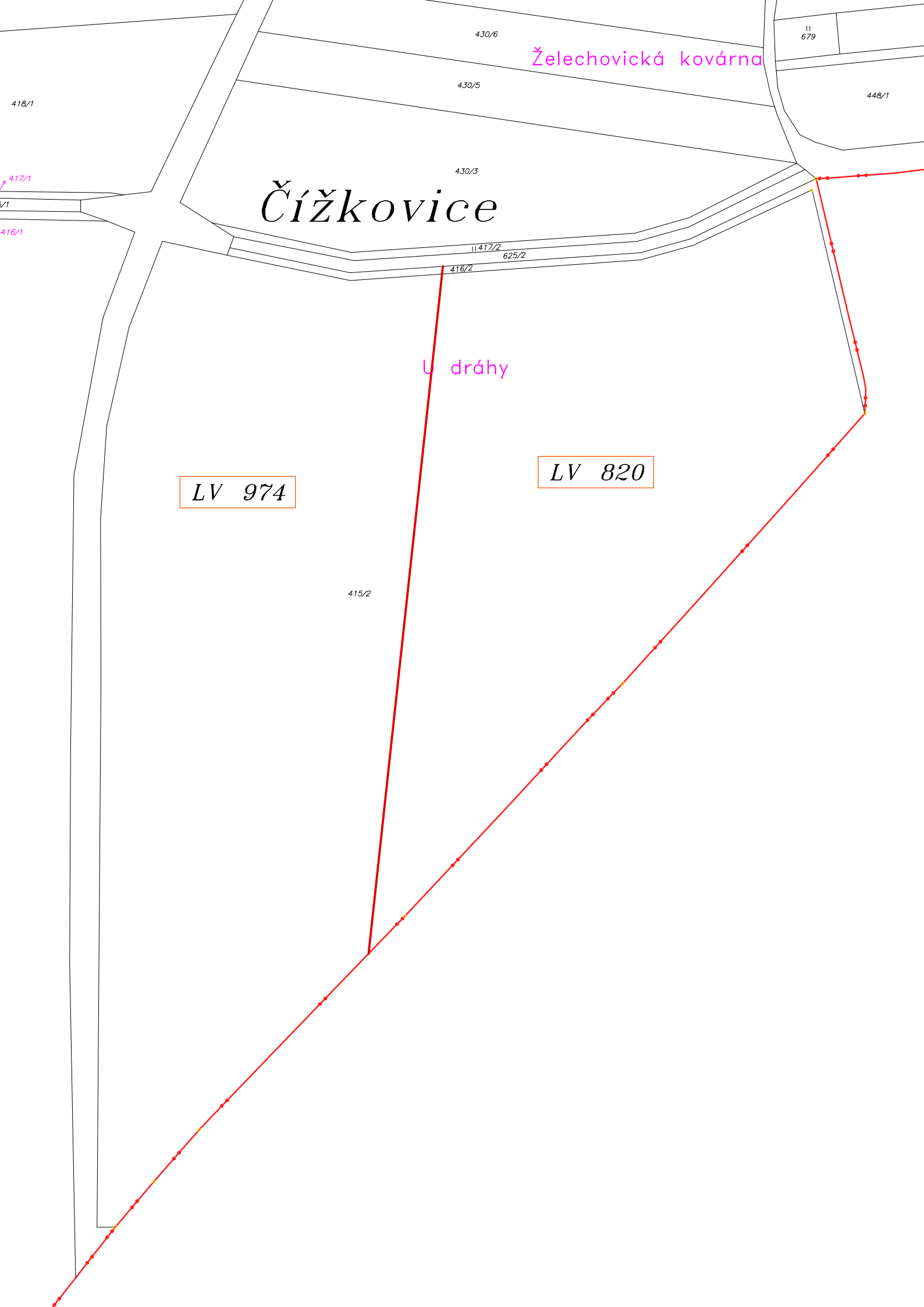

Čížkovice

Želechovická kovárna

U dráhy

LV 974

LV 820

505/6

124/31

505/35 →

Jenčický potok

Čížkovice

U mlýna

II
498/2

496/3

505/5

497 II

505/33

505/34

496/5

II
496/1

LV 155

II 506/3

LV 413

496/4

LV 122

673/7

494/2

LV 339

II
496/2

673/8

673/9

495/1

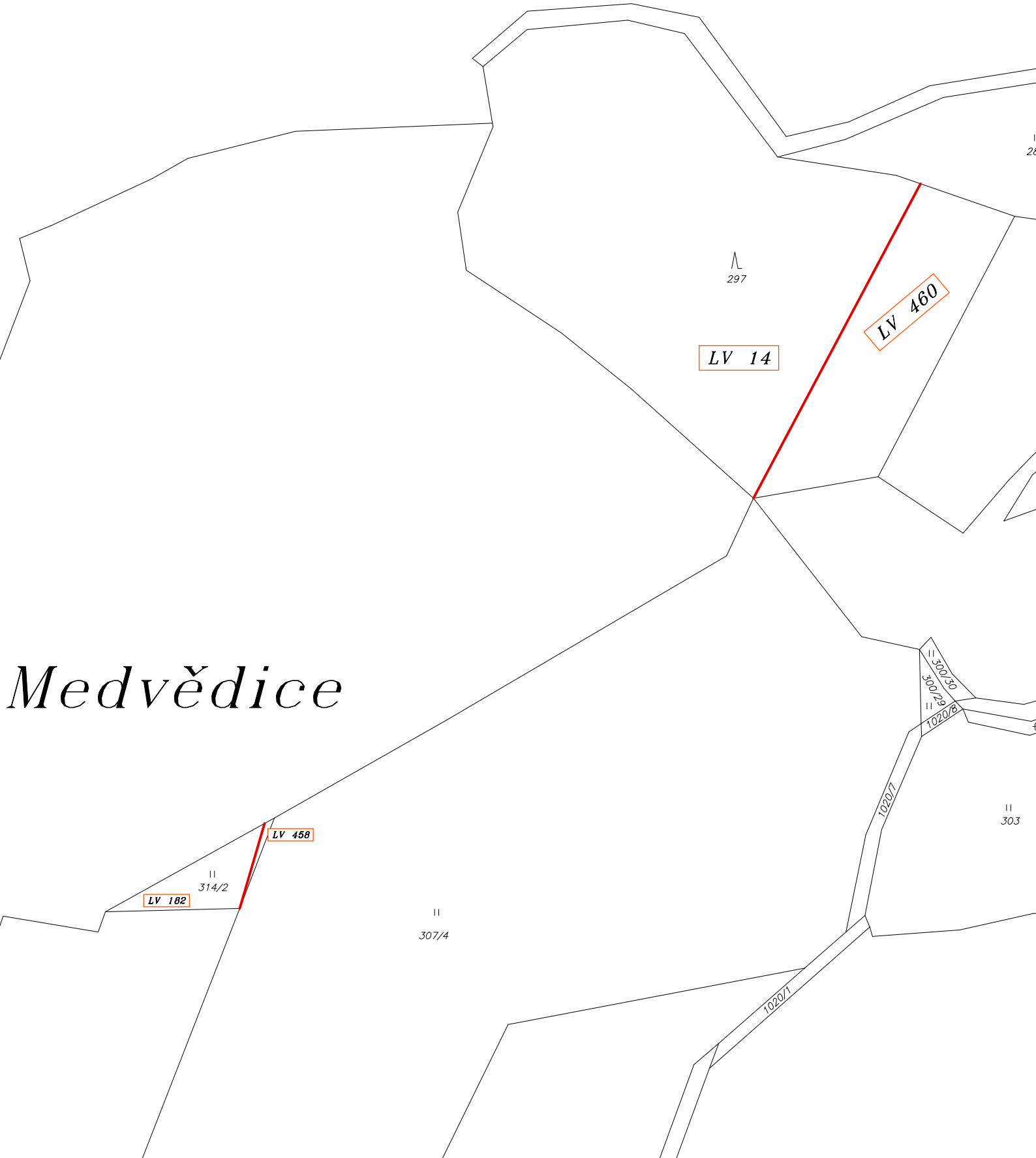

Medvědice

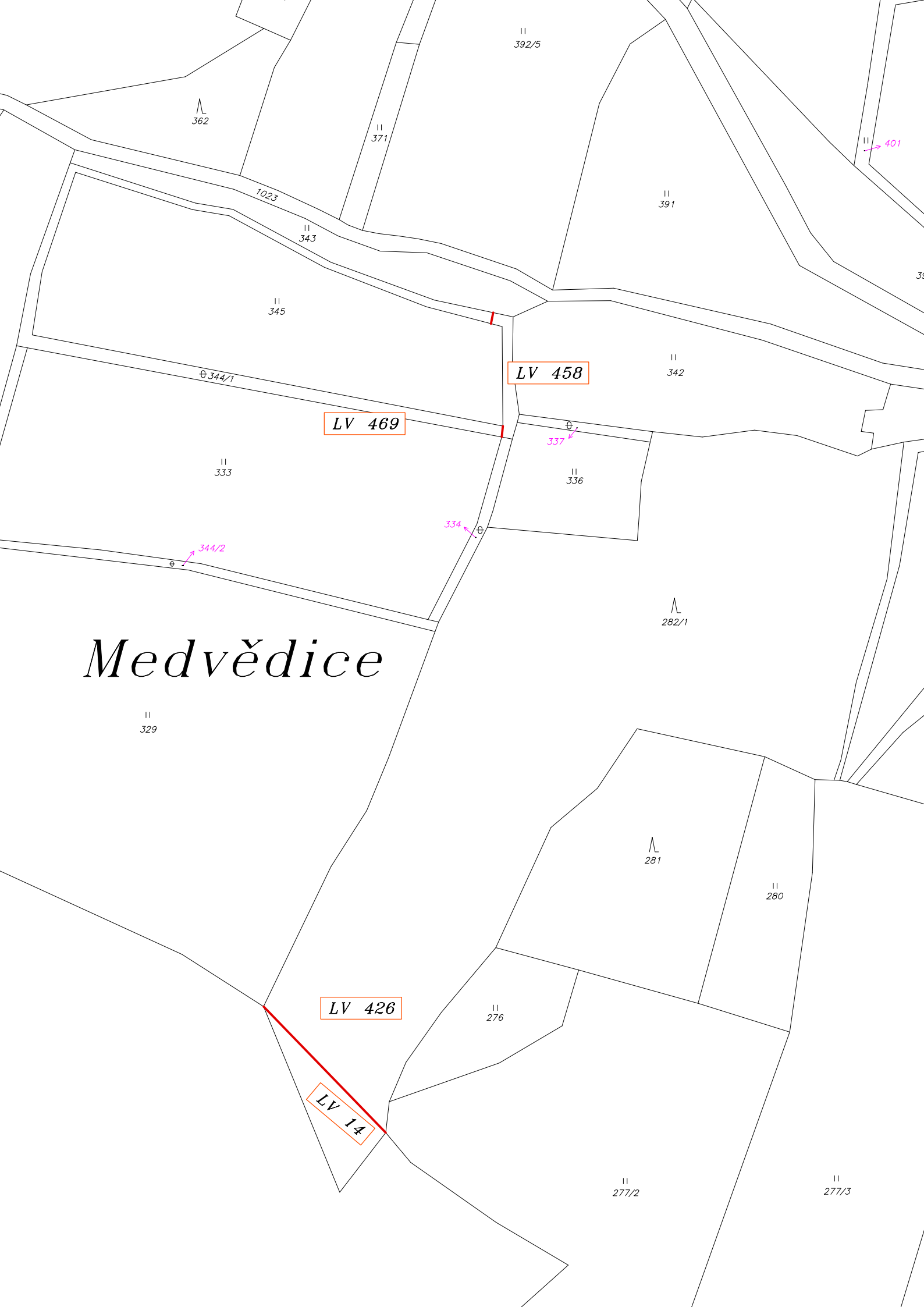

Medvědice

LV 458

LV 469

LV 426

LV 14



II
426

⊕ ↗ 429/26

II
429/42

II
510

Medvědice

II
50

LV 149

II
428/2

LV 195

II
428/1

LV 195

⊕
472/1

⊕
472/2

⊕
552

∧
522

1035

⊕ 518

||
520

||
517

LV 195

||
511

||
26

Medvědice

LV 442

||
514

||
510

||
506

||
507

∧
505

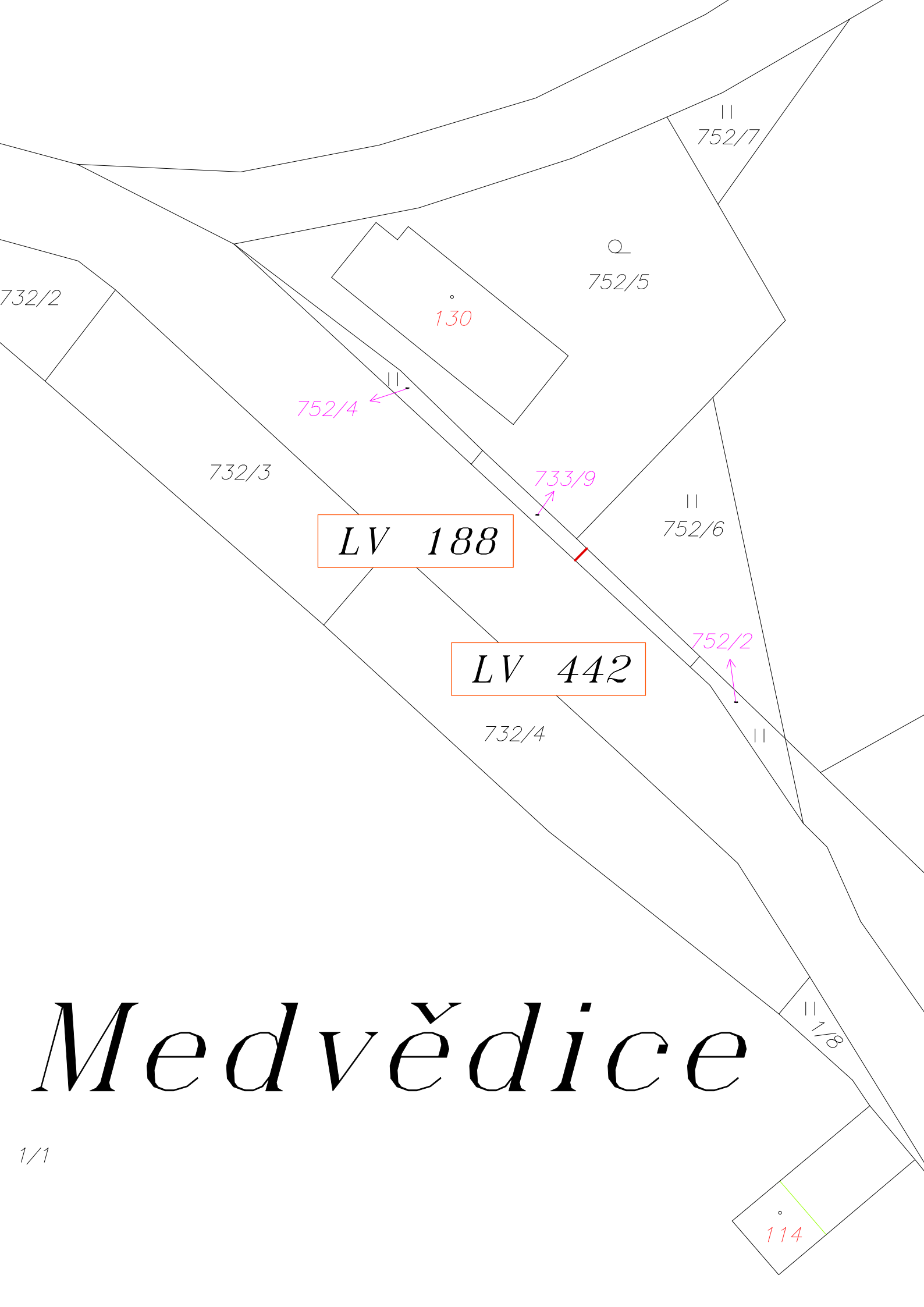

Medvědice

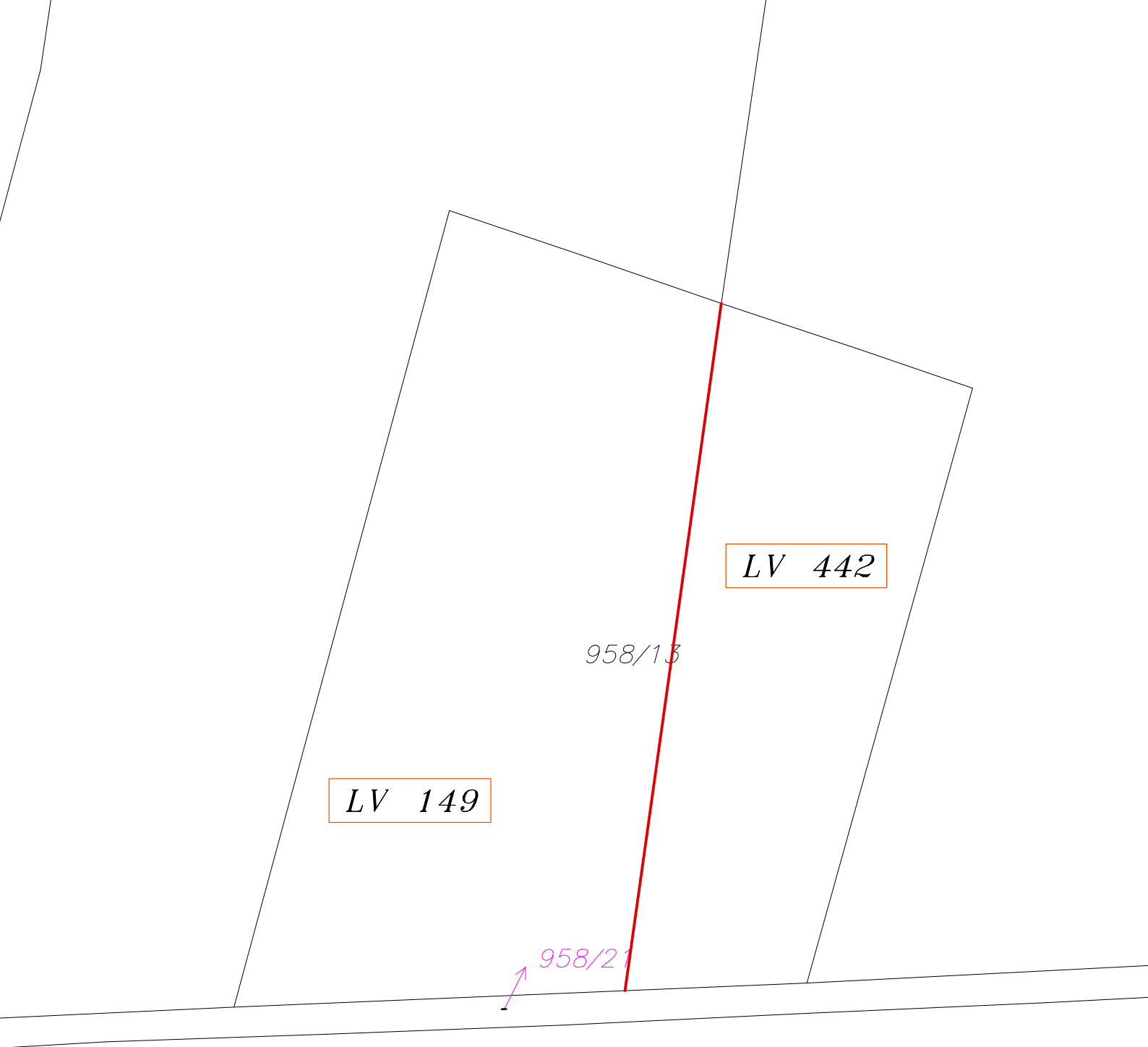

Medvědice